

Completa linha de conexões com estrutura de alta tecnologia **SPEEDFIT** PP - POLIETILENO



How Super Speedfit Works

To make a connection, the tube is simply pushed in by hand. The unique patented John Guest collet locking system then holds the tube firmly in place without deforming it or restricting flow.

Mechanism of construction
Super Speedfit fittings are made up of three components. **Bushes** are produced in an axial expansion or polypropylene. **Collets** are made of brass or PPSU. **Coillets** are produced in axial expansion or polypropylene with recessed steel teeth.

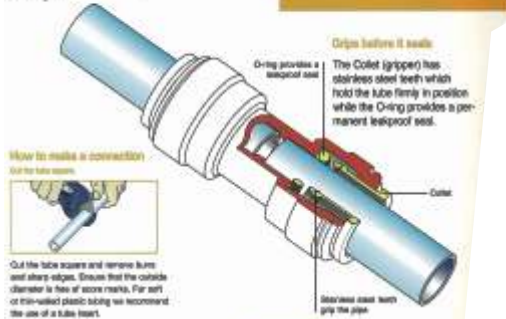

How to make a connection

- Prepare the tube ends**
Cut the tube square and remove burrs and sharp edges. Ensure that the outside diameter is free of score marks. For soft or thin-walled plastic tubing we recommend the use of a tube inserter.
- Push up to tube stop**
Push the tube into the fitting, to the tube stop.
- Push down to seat**
Pull on the tube to check it is secure. Test the system before use.

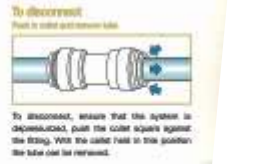

How to make a John Guest Connection

To make a connection, the tube is simply pushed in by hand to the unique patented John Guest collet locking system. This holds the tube firmly in place without deforming it or restricting flow.

Mechanism of construction
John Guest fittings are made up of three components. **Bushes** are produced in axial expansion or polypropylene. **O-rings** are produced in axial expansion or polypropylene with recessed steel teeth.

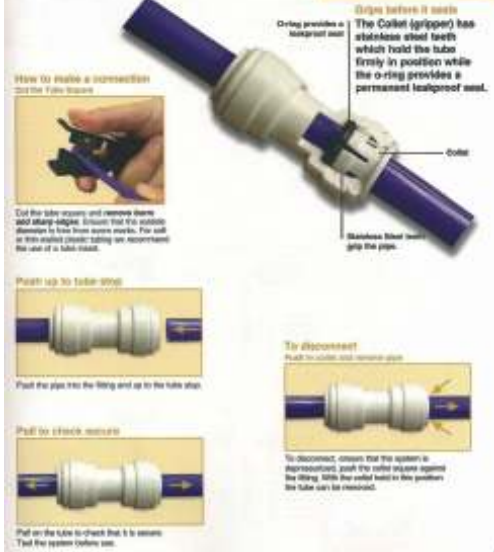

Speedfit

MAKING A GOOD CONNECTION:



Like our Standard Fittings, Twist and Lock Fittings, have a collet with stainless steel teeth that grip the pipe when fully inserted, and an o-ring to provide a permanent leak-proof seal. The additional benefit of the Twist and Lock fitting is that a twist of the screw-cap gives greater compression on the o-ring seal and locks pipe in place for greater security.



To prevent damage to the o-ring remove all burrs and sharp edges. When using Speedfit® pipe, we recommend the use of Supersal® Pipe Inserters. The insert should only be used with Speedfit® Pipe.



The stem of the insert gives greater rigidity to the length of pipe within the fitting, reducing the chance of leaks if a side load is applied.

